

5 Year Warranty

Gusher® Galley

The simple solution for fresh water delivery in small galleys

Whale Manual Self Priming Galley Pumps - Simple Foot Operated Solution For Pumping Water In The Galley

Whale manual self priming galley pumps - simple foot operated solution for pumping water in the galley

- Smooth double action
- Self primes and operates dry without damage
- Easy, smooth hands free operation
- Ease of installation - Multi-directional inlet and outlet hose connections
- 3 mounting options (including thru bulkhead)
- Left and right oriented foot lever versions available
- Also ideally used to prime Whale In-Line Booster pumps
- Pumps fresh and salt water
- 15 ltrs (4 US gals) per minute

Straight forward installation
multi-directional inlet and outlet ports
Simple plumbing - Suitable for Whale Quick Connect 15mm plumbing and 13mm (1/2") flexible hose connections

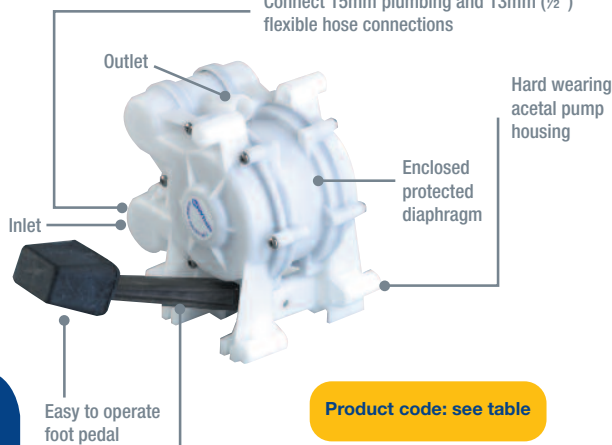

Product code: see table

Model to suit most galley layouts left /right lever options available

Note - left lever mount version shown

COMPLETE YOUR SYSTEM

Freshwater system accessories such as water filters, and pipework connections – page 76-77

YOU MAY ALSO LIKE

- Whale water filters – page 76
- Whale inline booster pumps to fit with Gusher Galley – page 60
- Watermaster Automatic Pressure Pumps – page 54

Product Information

Model Specifications

Model	Gusher® Galley Mk 3	
Product Code	GP0550	GP0551
Lever Mounting	Right	Left
Weight	0.7 kg (1.5 lbs)	
Hose Connections	Suitable for Connection to Whale Quick Connect 15 mm Plumbing 13 mm (1/2") Flexible Hose	
Materials	Pump Body: Acetal, Nylon. Lever: LM6 Aluminium Alloy Diaphragm: Nitrile®, Neoprene, Fasteners: Stainless Steel	
Service Kit	AK0553 - Service Kit for Gusher® Galley (suitable for Mk 3 only) Contains: Diaphragm, Valves and Seals AS0556 - Piston and Operating Kit	
Maximum Suction Lift	2 m (7 ft)	
Maximum Discharge Head	3 m (10 ft)	
Maximum Output per Minute	15 ltrs (4 US gals)	

Note: These specifications are retail items only.
For details of our bulk pack range for boat builders and wholesalers - contact Whale Support.

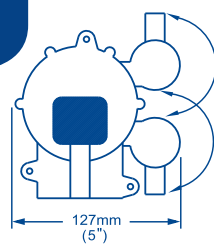
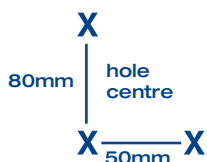

Front View

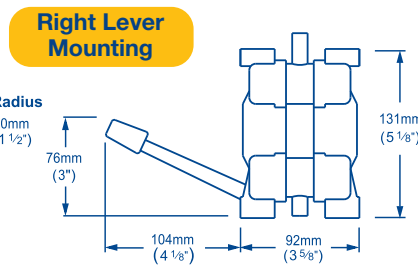

Side View

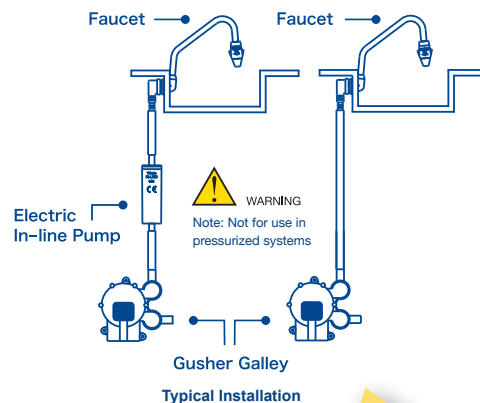

Gusher Galley
Typical Installation



Manual Galley Pump - Foot Operated

Gusher® Galley Mk 3 Pump (Introduced 1984)

Gusher® Galley Mk 3 Pump GP0550 (Right Hand Version) GP0551 (Left Hand Version) - Foot Operated Fresh Water Pump.

Note* Contained in Service Kit AK0553 - Introduced 1984

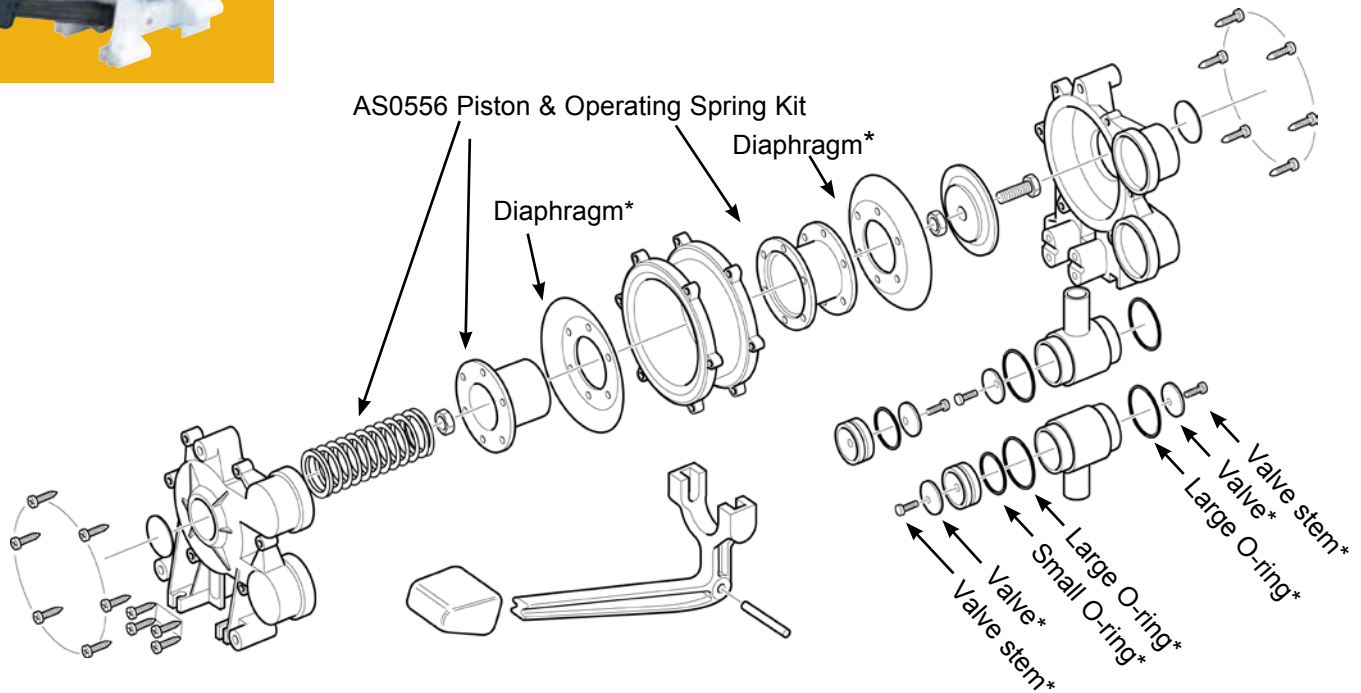

Accessories

WF1530 Silverised Carbon Water Filter (inline)

Service Kits

AK0553 Service Kit with Complete Set of Serviceable Parts for Whale Gusher® Galley Mk 3

Qty	Containing
2	Small O-ring
4	Valve
4	Valve stem
4	Large O-ring
4	Self tapping screw
1	Sealing washer
2	Diaphragm

AS0556 Piston & Operating Spring Kit

Qty	Containing
1	Nut M6
1	Operating spring
1	Clamping cup
1	Piston
1	Clamping plate
1	Sealing washer
1	Screw M6



WF1530



AK0553



AS0556