



FCC Statement

This equipment has been tested and found to comply with the limits for a Class B digital device, pursuant to Part 15 of FCC Rules. These limits are designed to provide a reasonable protection against harmful interference in a residential installation. This equipment generates, uses and can radiate radio frequency energy and, if not installed and used in accordance with the instructions, may cause harmful interference to radio communications. However, there is no guarantee that interference will not occur in a particular installation. If this equipment does cause harmful interference to radio or television reception, which can be determined by turning the equipment off and on, the user is encouraged to try and correct the interference by one or more of the following measures:

- reorient or relocate the receiving antenna.
- increase the separation between the equipment and receiver.
- connect the equipment into an outlet on a circuit different from that to which the receiver is connected.
- consult the dealer or an experienced radio/TV technician for help.

IMPORTANT:

1. Some features described in this manual are not available on every model. In particular, DSC functions are NOT available on the 7000.

2. DSC functions will not operate on the 7100US or the 7100EU until your MMSID has been entered. Refer to section 4.2 for details.

2. The radio channels installed into the Navman VHF radio may vary from country to country, depending upon the model, and government or national communications authority regulations.

3. Navman NZ Ltd recommends that you check the radio operating licensing requirements of your country before using the Navman VHF radio. The operator is solely responsible for observing proper radio installation and usage practices.

4. A DSC warning label is supplied with the 7100US. To comply with FCC regulations, this label must be affixed in a location that is clearly visible from the operating controls of this radio. Make sure that the chosen location is clean and dry before applying this label.

It is the owner's sole responsibility to install and use the instrument in such a manner that will not cause accidents, personal injury or property damage.

Navman NZ Limited disclaims all liability for any use of this product in a way that may cause accidents, damage or that may violate the law.

Governing Language: This statement, any instruction manuals, user guides and other information relating to the product (Documentation) may be translated to, or has been translated from, another language (Translation). In the event of any conflict between any Translation of Documentation, the English language version of the Documentation will be the official version of the Documentation.

This manual represents the Navman VHF 7000, 7100US, and 7100EU radios at the time of printing. Navman NZ Limited reserves the right to make changes to specifications without notice.

Copyright © Navman NZ Limited, New Zealand. All rights reserved. NAVMAN is a registered trademark of Navman NZ Limited.

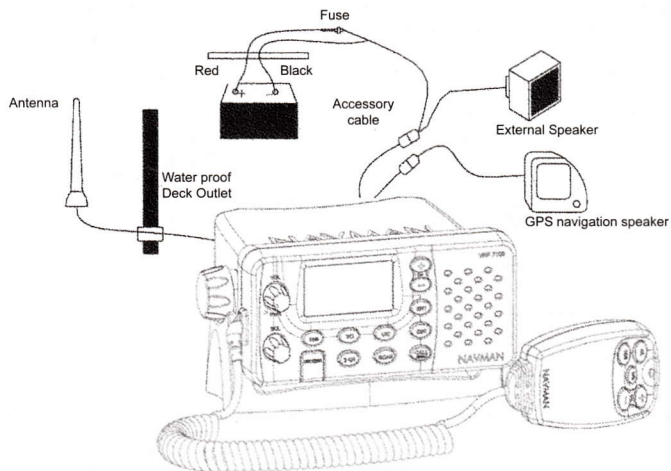

This Navman radio is designed to generate a digital maritime distress call to facilitate search and rescue. To be effective as a safety device, this radio must be used only within the geographic range of a shore-based VHF marine Channel 70 distress and safety watch system. The geographic range may vary but under normal conditions is approximately 20 nautical miles.

DSC functions are NOT available on the 7000. A DSC warning label is supplied with the 7100US and 7200US. To comply with FCC regulations, this warning label must be affixed in a location that is clearly visible from the operating controls of this Navman radio. Make sure that the chosen location is clean and dry before applying this label.

S/N 4-0-V-12-0077
VHF 7200

Checklist (pictured over)

The following items should be supplied in the box. Check before starting the installation and contact your dealer if an item is missing. *Note that an antenna is not provided with the VHF Radio. Consult your Navman dealer for advice if necessary.*

1. Mounting gimbal for the VHF radio
2. Power supply cable and external speaker connection cable
3. Two mounting knobs
4. Microphone bulkhead mount
5. GPS connection cable
6. Four self-tapping screws for the mounting gimbal
7. Four flat screws for the mounting gimbal
8. Four plain washers for the mounting gimbal
9. Four spring washers for the mounting gimbal
10. Four nuts for the mounting gimbal
11. Two self-tapping screws for the microphone bulkhead mount
12. Two flat screws for the microphone bulkhead mount
13. Two plain washers for the microphone bulkhead mount
14. Two spring washers for the microphone bulkhead mount
15. Two nuts for the microphone bulkhead mount.

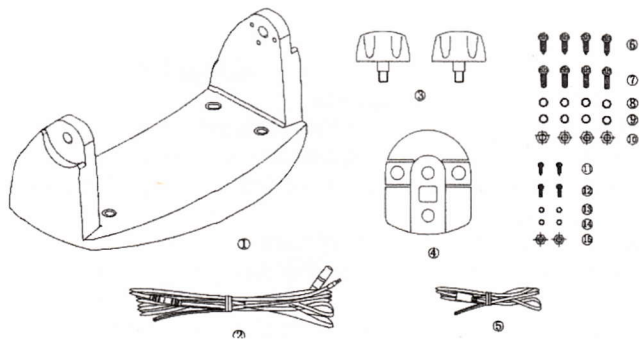

Checklist (middle picture opposite)

16. Two flush mount kit brackets
17. Two M5x32 screws
18. Two M5x10 screws
19. Two lock nuts
20. Two plastic bulkhead bushings.
21. Installation template (not pictured)
22. Two 7 Amp spare fuses (not pictured) in case of accidental reverse of the battery polarity

Installation Options

There are two ways to install the radio. You can choose:

- a *deck or overhead mounted gimbal installation*. The reversible mounting gimbal is fixed to a suitable site and the radio is placed into it. The radio can be removed for storage and the viewing angle can be adjusted.
- a *recessed installation*. The radio is recessed into a cavity cut into a bulkhead. The radio fixture is permanent and the viewing angle cannot be adjusted.

Location Requirements - *Please check these **before** doing any cutting or drilling.*

Whichever installation method you choose, ensure that the chosen location:

- is at least one metre (3') from the antenna
- allows easy connection to (at least) a 10 Amp fused 13.6V DC electrical source and the antenna
- is at least 45cms (1.5') from the compass to avoid creating magnetic deviation of the compass during radio operation
- has a suitable space close by for installing the microphone bulkhead mount
- provides easy access to the front panel controls
- provides reasonable access to the wiring at the back of the radio
- provides enough room to fix the DSC warning label (*7100US and 7200US*).

Gimbal Installation

1. Hold the mounting gimbal at the chosen location and use a soft pencil to mark the screw hole positions onto the mounting surface.
2. *If you cannot reach behind the mounting surface to attach the nuts, use the 5mm self-tapping screws instead of the flat screws shown in the picture. If you are drilling into fiberglass, use a drill bit smaller than 5mm to drill the pilot holes.*
Otherwise, drill the four screw holes where marked, using a 5mm (3/16") drill bit. Drill completely through the mounting surface.
3. Use a Philips screwdriver and the set of four flat screws, spring washers, plain washers, and nuts to attach the mounting gimbal to the location site.
4. Slide the radio into the mounting gimbal.
5. Insert the two mounting knobs through the holes and tighten them sufficiently to hold the radio at the desired viewing angle.

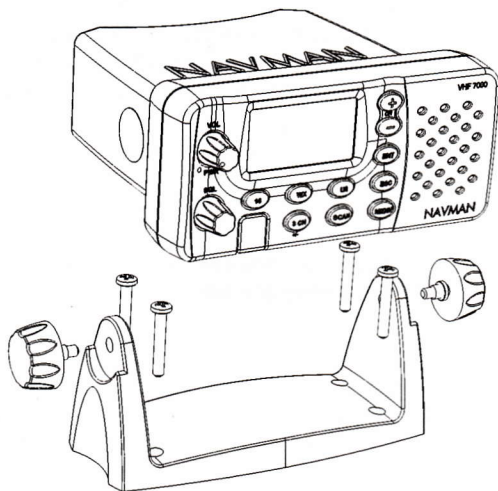

Changing the Viewing Angle

The viewing angle has a 20° tilt range. To change the current viewing angle on a gimbal mount:

1. Support the radio then loosen the mounting knobs until the radio can be moved.
2. Re-position the radio then tighten the mounting knobs again.

Recessed Installation (picture below)

1. Tape the installation template onto the chosen location site.
2. Cut out the area marked by the solid dark line. (The dashed line indicates the total area that will be covered by the radio fascia after installation.)
3. Remove the installation template and slide the radio into the cavity.
4. Working from the rear of the bulkhead, align the ratched outstand on each side of the radio with the central hole in each mounting bracket.
5. Use the two short M5x10 screws to screw the mounting brackets to the sides of the radio.
6. Slide each M5x32 screw through the screw hole in the mounting bracket, then attach the lock nut and the stopper. *If your bulkhead exceeds 13mm, the stopper nut can be discarded if necessary.*
7. Tighten the M5x32 screws until the radio is held against the rear of the bulkhead.
8. Tighten up the lock nuts to secure the installation.

Connecting the Radio

There are three sockets at the rear of the radio, as shown. The combined power & speaker socket and the GPS socket have short connectors already in place but further electrical wiring is required at the rear of the radio.

GPS connector. Line up the arrow on the connector with the arrow on the GPS cable (supplied) and then plug together. The GPS cable has eight pins as follows:

Pin	Wire	Function
1	Red	Not used. (No connection)
2	Orange	NMEA OUT (+) (not used)
3	White	Program or clone select (not used)
4	Yellow	NMEA IN (+) (from GPS)
5	Green	NMEA IN (-) (from GPS)
6	Black	NMEA OUT (-) (Ground, not used)
7	Blue	NAVBUS (not used on 7000 or 7100) +
8	Grey	NAVBUS (not used on 7000 or 7100) -

Combined Power & Speaker connector. The end of the connector splits into three.

Red Power. 13.6V DC (+). Connect this to the positive battery terminal. Use at least a 10 Amp fused 13.6V DC electrical service to the radio.

Black Ground (-). Connect this to the negative battery terminal.

An external speaker cable with a 3.5mm male jack is supplied. Plug together. Use a 4 Ohm 4 Watt external speaker. White is SPEAKER (+) and Black is SPEAKER (-).

Antenna. Not supplied. A suitable radio antenna must be mounted and connected before operating the radio. Consult your Navman dealer for advice, if necessary.

Refer to the picture on the front page for an overview of the completed connections.



NOW

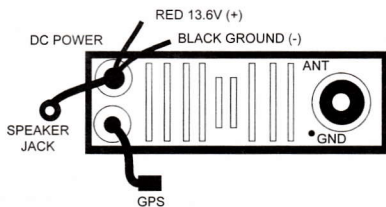

SUGGEST

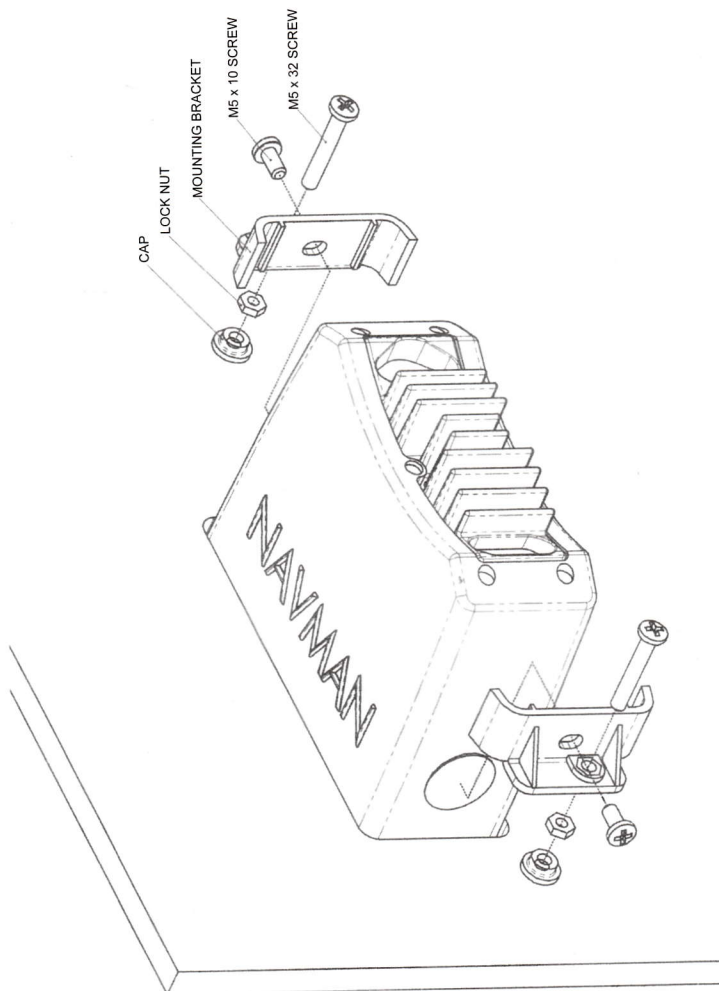

User MMSID (7100 and 7200 only)

You must obtain a user MMSID (Marine Mobile Service Identity) and enter it into your 7100 or 7200 in order to use the DSC functions. Contact the appropriate authorities in your country. If you are unsure who to contact, consult your Navman dealer. The user MMSID is a unique nine digit number, similar to a personal telephone number. It is used on marine transceivers that are capable of using DSC (Digital Select Calling).

You cannot make any DSC transmissions until you have obtained an MMSID and entered it into your 7100 or 7200.

Entering your user MMSID is ONCE ONLY operation.

1. Press and hold CALL/MENU to display the menu.
 2. Press +CH- or rotate the knob to select DSC SETUP, then press ENT.
 3. Press ENT to select USER MMSID. A dashed line appears.
 4. Enter your user MMSID along the dashed line. Use an alphanumeric microphone or the +CH- key. Press ENT to confirm each correct entry. If you make an error, press - until < is displayed, then press ENT to backup and correct the entry.
 5. When your MMSID number is entered correctly, press ENT to store it.
 6. You must re-enter your MMSID again as a password check, then press ENT to store it permanently.
- You can view your stored MMSID anytime in the DSC SETUP screen.

NAVWMAN

Ø 12.0mm / 1/2"

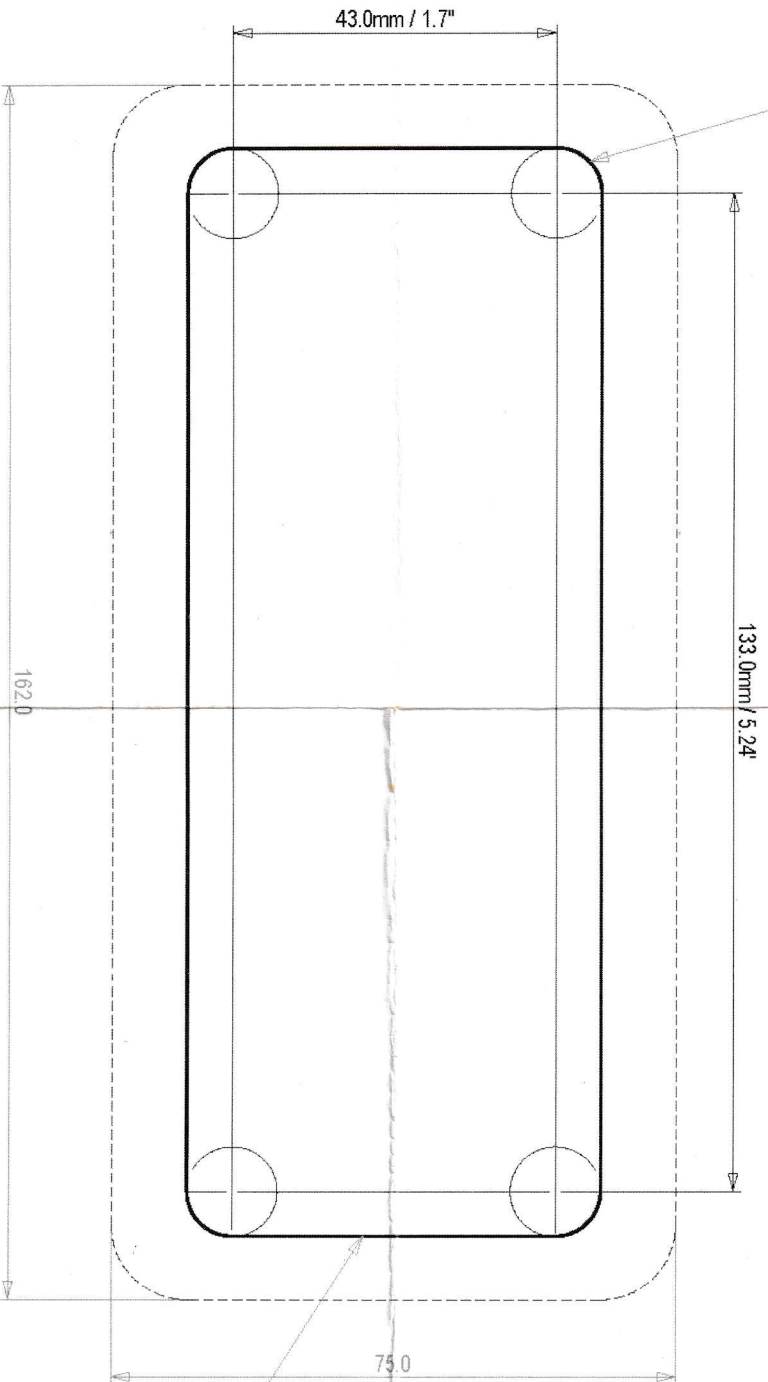

Model No's
VHF7000
VHF7100
VHF7200

